

ELECTRONIC METERS



Oval gear meters

The electronic oval gear meters for product delivery control and measurement are used in the private distribution of low, medium and high viscosity fluids such as fuel, lubrication oil and other special fluids compatible with the construction materials. The oval gear measuring principle adopted offers high precision and low pressure losses together with a compact lightweight design and easy installation.

An electronic card with microprocessor permits control of the display and calibration of the meter. A complete range of models is designed to satisfy all flow rate requirements. Ease of use, compactness and

the independent battery power supply make these products suitable for installation in both stationary systems on fluid transfer and distribution lines and in mobile applications as an accessory for delivery valves and guns and for all other industrial applications that require fluid delivery control.

Performance

- Precision $\pm 0.5\%$ in flow rate range after calibration
- Repeatability 0.2%
- Pressure loss < 0.5 bars (7 psi) at max flow rate

Construction features

- Body with aluminium measuring chamber
- Oval gears made of acetalic resin
- Aligned inlet/outlet apertures provided with female thread
- Versions K600 & k900 with flange
- Integrated suction filter (not present in model K400 / K200)
- Pulse signal type: raw signal (reed switch), single channel
- Electronic card with LCD housed in cover 5-digit partial total (h= 11.5 mm) with floating point from 0.001 to 999.99 8-digit non-resettable total (h= 5 mm) from 1 to 99999999
- Battery power supply 2 x 1.5 V
- Resettable total available
- Flow rate indication (only for K600/K900).



K200

Flow rate 2,5 l/min
Accuracy +/- 0,5%
I/O 1/8"



K400

Flow rate 30 l/min
Accuracy +/- 0,5%
I/O 1/2"



KA400 PTB

Flow rate 10 l/min
Accuracy +/- 0,5%
I/O 1/2"



Approved version available

K600/3

Flow rate 100 l/min
Accuracy +/- 0,5%
I/O 3/4" - 1"



K600/4

Flow rate 150 l/min
Accuracy +/- 0,5%
I/O 1 1/2"



K900

Flow rate 500 l/min
Accuracy +/- 0,5%
I/O 3"

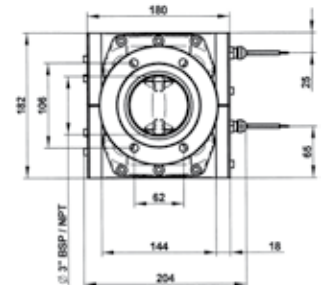
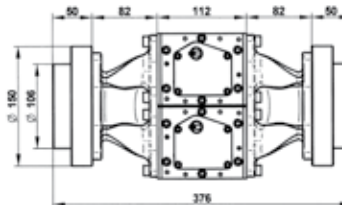

K 900

Code	Description	Flow rate		Pressure		2 x 1,5 V	Inlet filter	I/O	Inlet filter	Weight Kg	Packaging mm
		l/min	gal/min	bar	psi						
F0043012A	K200	0,1 - 2,5	0,03 - 0,66	550	7810	●	-	1/8" G	-	0,6	310x170x55
F0047500A	K400	1 - 30	0,26 - 7,9	70	994	●	-	1/2" G	-	0,5	80x80x75
F0048000A	K400 QT/NPT	1 - 30	0,26 - 7,9	70	994	●	-	1/2" NPT	-	0,5	80x80x75
000483020	K400 windscreen	1 - 30	0,26 - 7,9	70	994	●	-	1/2" G	-	0,5	80x80x75
F00496A20	K600/3 oil	6 - 60	1,58 - 15,8	70	994	●	●	3/4" G	●	1,6	200x120x140
F00496A00	K600/3 diesel	10 - 100	2,64 - 26,4	30	426	●	●	1" G	●	1,6	200x120x140
F00496A40	K600 GAL/NPT	10 - 100	2,64 - 26,4	30	426	●	●	1" NPT	●	1,6	200x120x140
00049700A	K600/4	15 - 150	3,9 - 39	20	284	●	●	1 1/2" G	●	3,2	200x120x140
F0049701A	K600/4 GAL/NPT	15 - 150	3,9 - 39	20	284	●	●	1 1/2" NPT	●	3,2	200x120x140
F0049900A	K900	50 - 500	13,2 - 132	20	284	●	●	3" G	●	12	400x290x200
F0049903A	K900 GAL/NPT	50 - 500	13,2 - 132	20	284	●	●	3" NPT	●	12	400x290x200

Upon request available in NPTF version and Display in Gallon/Quarter or Pint