



www.lsidef.com

EN Pulse / valve unit

This component is for installation along the supply lines feeding the pumps in a centralised oil (or other fluid) distribution system. It combines the functions of an on-off valve with those of a flow-meter. This unit simplifies the realisation of a refuelling system because with a single hydraulic coupling and an electric connection you can install all the components needed to regulate the flow of fluids.

Performance Specifications

- Power supply: 24 V AC, 12 V DC, 24 V DC.
- Flow-rate (range): 2 ÷ 30 l/min (0,5 ÷ 7,9 gal/min).
- Viscosity (range): 9 ÷ 5000 cst.
- Max operating pressure: 70 bar (994 psi).
- Bursting pressure: 140 bar (1880 psi).
- Head loss: 4.8 bar (16 l/min with SAE W80/20° oil).
- Accuracy: ± 0.5% of flow range after calibration.
- Operating temperature (range): -5°C ÷ 40°C.
- Humidity: 10% ÷ 90% (max).
- Filter mesh: 150 microns
- Compatible fluids: oil, antifreeze.

Technical Features

- Aluminium casing, 1/2" inlet, 1/2" outlet.
- Wire-mesh filter, easy to access for cleaning.
- Monostable valves (stable position: shut). The GPVS model comes with a single valve, the GPV model has 2 valves, one of which for reduced flow rates.
- Oval-gear metering system (acetalic resin gears).
- Single-channel pulses. Double-channel version also available.
- "Clean contact" pulses.
- IP23 casing protection.
- Special versions for other fluids.

Flow rate 2 ÷ 30 l/min

Accuracy +/- 0,5%

Viscosity (range) 9 ÷ 5000 cSt

Work pressure 70 bar

Filter mesh 150 μ

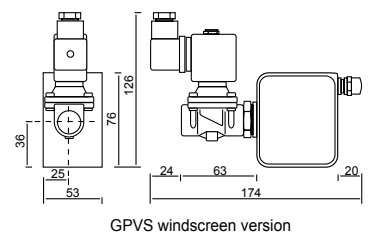
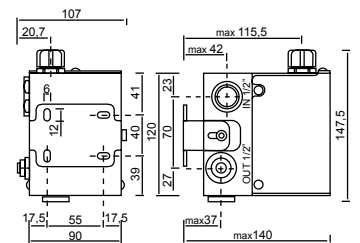
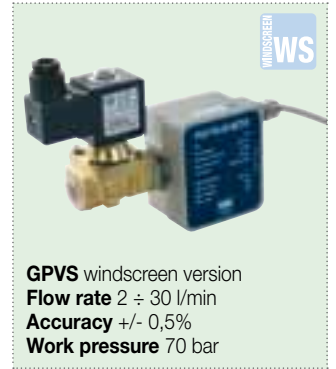
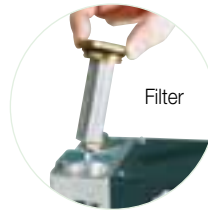
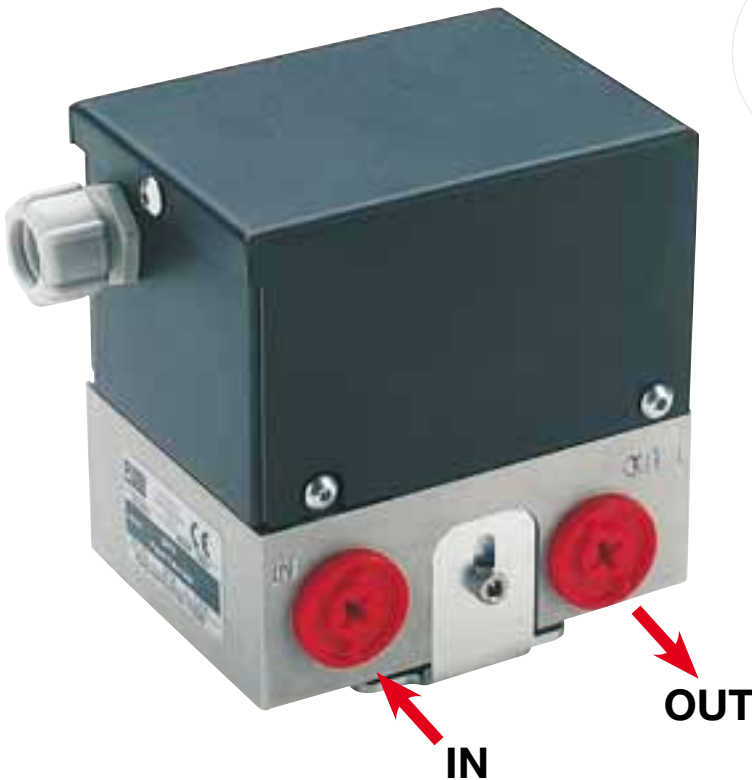

GPV

Code	Description	Supply tension	Valve No.	Weight Kg	Packaging mm
000445080	GPV 12 Vdc	12 Vdc	2	3	200x120x140
000445000	GPV 24 Vdc	24 Vdc	2	3	200x120x140
000445060	GPVS 24 Vac	24 Vac	1	2,8	200x120x140
000445090	GPVS 12 Vdc	12 Vdc	1	2,8	200x120x140
000445020	GPVS 24 Vdc	24 Vdc	1	2,8	200x120x140
000445160	GPVS 24 Vdc windscreen	24 Vdc	1	1,1	200x320x90
000445170	GPVS 24 Vac windscreen	24 Vac	1	1,1	200x320x90

NPTF version available